

# On-Premises Barrier Washer-Extractors

## SB700, SB900, SB1100, SB1400, SB1800

### Features

- Freestanding, high spin
- Stainless steel cabinet
- Stainless steel drum and tub
- MICRO – new graphic display with almost unlimited possibilities as:
  - communication interface enabling remote service
  - multilingual microprocessor
  - freely programmable
- Oversized frame, bearings and drum
- Large door opening for easy loading and unloading
- Large drain valve (Ø126mm)
- Easy access to all parts
- Frequency controlled motor
- Perforated lifting ribs: more mechanical action and lower water consumption
- Standard Y-pocket (3 pockets) drum on SB1100, SB1400, SB1800
- Standard Pullman (2 pockets) drum on SB700, SB900

- Eco-friendly washing programs – significantly reduces water and electricity consumption
- Soap dispenser with 5 removable compartments (10 compartments on SB1800)
- Automatic door positioning
- Air operated water inlets
- Air suspension

### Options

- Liquid soap pumps
- Drum with 2 pockets on SB1100, with 3 pockets on SB700, SB900
- Tap to take water samples
- Light and sound signalisation of end of washer cycle
- Second display
- Horizontal door (available only for SB1800)
- Second drain valve (Ø126 mm), or recycle valve ( for water recycling: Ø76mm)
- Version with only front door for loading and unloading



Control panel (MICRO)



Robust Design



Large Drain Valve



Large Door Opening



Hygienic Solution

# On-Premises Barrier Washer-Extractors

## Specifications

	SB700	SB900	SB1100	SB1400	SB1800
<b>INNERDRUM</b>					
Capacity 1:10 [kg/lb]	70/154	90/198	110/242	140/308	180/396
Volume [l]	700	900	1100	1400	1800
Diameter [Ø mm]	1000	1000	1100	1200	1300
<b>POCKETS</b>					
Frequency controlled	Standard 2 Optional 3	Standard 2 Optional 3	Standard 3 Optional 2	Standard 3 Optional 2	Standard 3 -
<b>MOTOR</b>					
Frequency controlled	Yes	Yes	Yes	Yes	Yes
<b>DRUM SPEED</b>					
Wash speed [rpm]	36	36	35	33	36
Spin speed [rpm]	800	800	754	720	695
G-Factor	360	360	350	350	350
<b>PROGRAMMER</b>					
Control model	MICRO	MICRO	MICRO	MICRO	MICRO
<b>CABINET</b>					
Stainless steel AISI 304	Standard	Standard	Standard	Standard	Standard
<b>DRUM</b>					
Stainless steel AISI 304	Standard	Standard	Standard	Standard	Standard
<b>HEATING</b>					
Electrical additional heating [kW]	54	54	72	72 / 96	-
Steam heating [bar]	6 - 8	6 - 8	6 - 8	6 - 8	6 - 8
<b>Connection</b>					
Electrical [V/Hz]	3×380-480V/50-60Hz 3×200-240V/50-60Hz	3×380-480V/50-60Hz 3×200-240V/50-60Hz	3×380-480V/50-60Hz 3×200-240V/50-60Hz	3×380-480V/50-60Hz 3×200-240V/50-60Hz	3×380-480V/50-60Hz 3×200-240V/50-60Hz
Water inlet [in(mm)]	3 × 1.5"(38) + 1 × ¾"(19)	3 × 1.5"(38) + 1 × ¾"(19)	3 × 1.5"(38) + 1 × ¾"(19)	3 × 1.5"(38) + 1 × ¾"(19)	3 × 1.5" + 1 × 1"
Steam inlet [in(mm)]	1"(25)	1"(25)	1"(25)	1"(25)	1"(25)
Compressed air inlet [Ø mm]	10	10	10	10	10
Drain [Ø mm]	126	126	126	126	126
<b>DIMENSIONS</b>					
Size HxWxD [mm]	1830×2025×1605	1830×2275×1605	1880×2325×1605	2100×2425×1805	2195×2585×1905
<b>TRANSPORT DATA</b>					
Gross weight - case packaging [kg]	2760	2970	3150	3760	5310
Net weight [kg]	2600	2810	2990	3550	4990
Volume (packed) [m³]	7.3	8.1	8.7	10.8	12.3
Case packing HxWxD [mm]	1985×2100×1740	1985×2355×1740	2080×2400×1740	2250×2485×1940	2265×2665×2040
<b>WATER CONSUMPTION</b>					
Cold and hot water per cycle* [l]	783 + 196	966 + 242	1179 + 296	1379 + 346	2250 + 0

Tested in accordance of EN 604 56 norm. The data concerning dimensions of machines include all extended parts.

# On-Premises Barrier Washer-Extractors

## Dimensions

	A	B	C	D	E	F	G	H	I	J	K	L	M	N	O	P
SB700	2025	1605	1830	1725	1000	636	750	1950	1500	1040	550	470	560	400	350	500
SB900	2275	1605	1830	1725	1250	636	750	2200	1500	1160	550	470	560	400	350	500
SB1100	2325	1605	1880	1775	1300	636	800	2250	1500	1190	550	470	560	400	350	500
SB1400	2425	1805	2100	1995	1382	636	900	2350	1700	1200	620	570	560	400	500	600
SB1800	2585	1905	2195	2090	1498	636	900	2510	1800	1255	650	408	1175	400	500	600

All measurements are in mm.

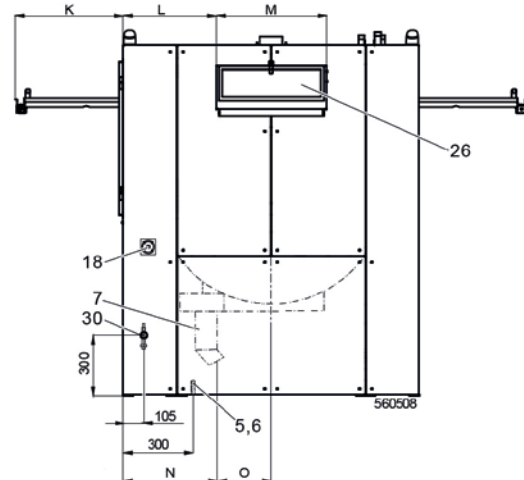
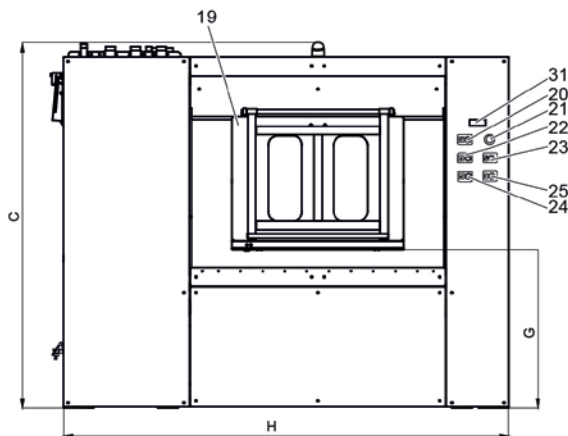
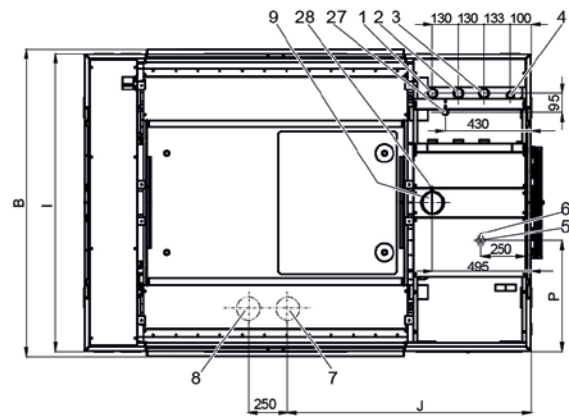
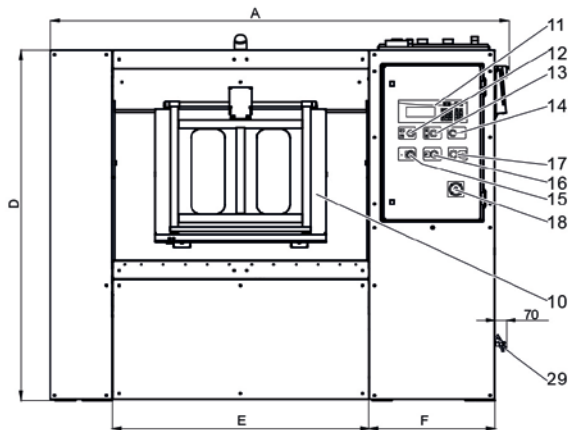

- |                                 |   |   |
|---------------------------------|---|---|
| 1 Hard cold water inlet         | 12 Change-over switch                                   | 22 Button of door locking                                 |
| 2 Soft cold water inlet         | 13 Signal of machine running (+ operating air pressure) | 23 Button of activation of loading side                   |
| 3 Hot water inlet               | 14 Central stop   | 24 Button of door unlocking                               |
| 4 Steam inlet                   | 15 Button of door unlocking                             | 25 Button of drum positioning                             |
| 5 Supply of pressure air        | 16 Button of drum positioning                           | 26 Soap hoppers   |
| 6 Power supply                  | 17 Button of door locking                               | 27 Soft cold water inlet into soap hoppers                |
| 7 Main drainage valve           | 18 Main switch  | 28 Liquid detergent inlet                                 |
| 8 Recycling drainage valve      | 19 Door of unloading (clean size)                       | 29 Drain valve, applicable for wash bath sample           |
| 9 Venting of the machine        | 20 Signal of loading                                    | 30 Drain connection 1½" – applicable for wash bath sample |
| 10 Door of loading (dirty side) | 21 Centralstop  | 31 Second display (on request)                            |
| 11 Programmer                   |   |   |